



**TOWN OF
THE BLUE MOUNTAINS**
Thornbury Municipal Harbour
41 Bruce Street North

Georgian Bay



41 Bruce St N

Access to:

- Docks E - F - G - H - I
- Harbour Master's Building
- First Aid - A.E.D.
- Fuel and Pumpout
- Fish Station
- Public Washroom
- Boater Showers
- Parking
- Pay Phone

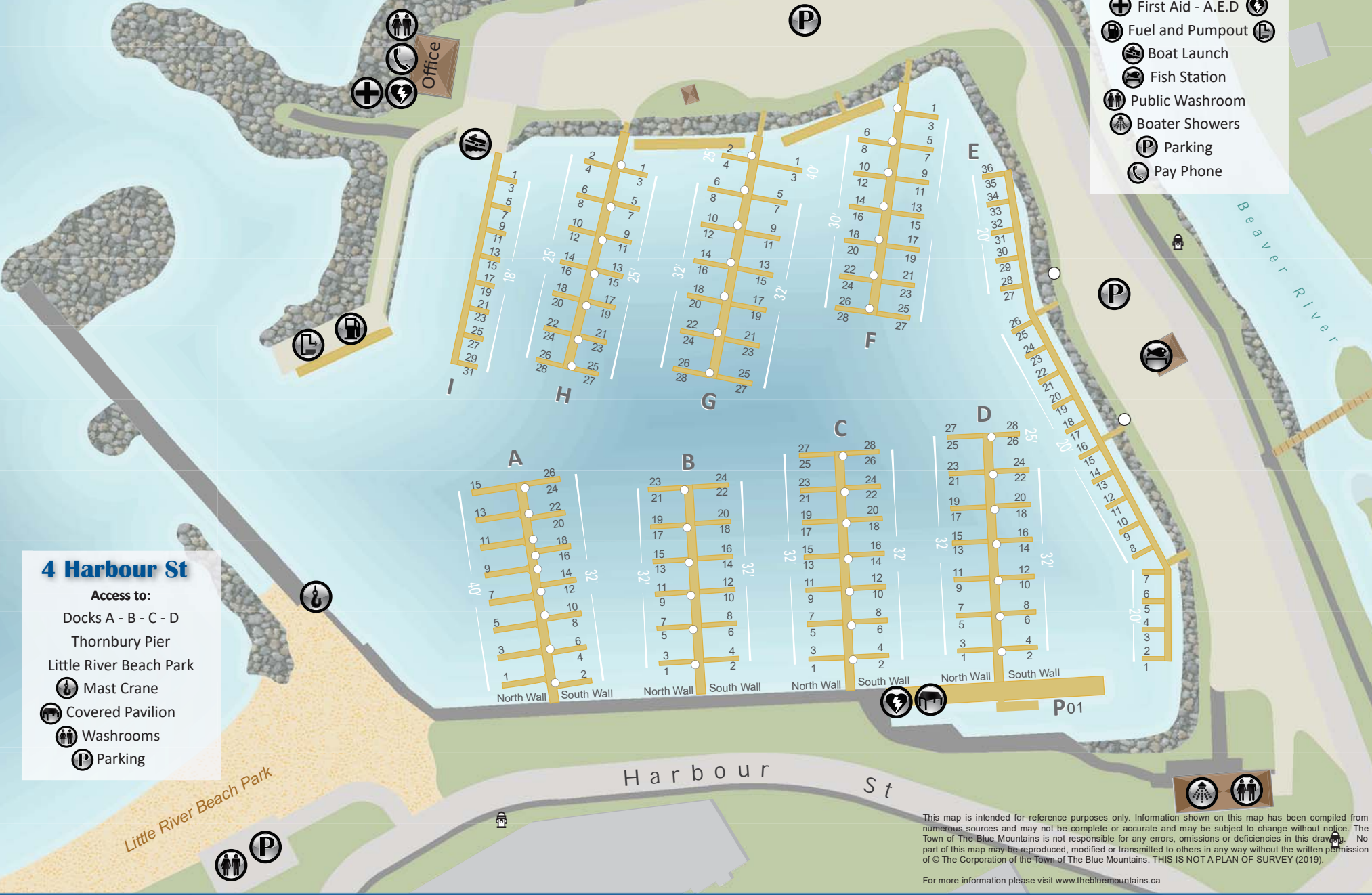

4 Harbour St

Access to:

- Docks A - B - C - D
- Thornbury Pier
- Little River Beach Park
- Mast Crane
- Covered Pavilion
- Washrooms
- Parking

This map is intended for reference purposes only. Information shown on this map has been compiled from numerous sources and may not be complete or accurate and may be subject to change without notice. The Town of The Blue Mountains is not responsible for any errors, omissions or deficiencies in this drawing. No part of this map may be reproduced, modified or transmitted to others in any way without the written permission of © The Corporation of the Town of The Blue Mountains. THIS IS NOT A PLAN OF SURVEY (2019).

For more information please visit www.thebluemountains.ca